



# REEL E-Z<sup>®</sup>

Portable Pumping and Sampling System



## DESCRIPTION

The *REEL E-Z* is a compact system designed to provide a convenient way to store and operate the Grundfos<sup>®</sup> RediFlo-2<sup>®</sup> Pump. When used with INW's HAPPY HOSE!<sup>®</sup> (cable, tubing and safety cable bonded together) the system easily installs the pump in the well, locks it in place and allows for easy take up and cleaning without cable entanglement. The roller guide protects the cable from well damage and the *REEL E-Z* can accommodate both above and below-grade well applications.

## OPERATION

The *REEL E-Z* system is used in portable sampling and pumping applications in small diameter wells as deep as 250 feet. The system can be purchased with optionally installed check valve to prevent back flow, or with a wheel kit for easier transport. INW also now offers the system installed only with Happy Cable! (combination electrical conductors and safety wire rope) for customers that want to use the system with various types of tubing.

## APPLICATIONS

- High & low flow sampling

## FEATURES

- Lightweight aluminum
- One-person portability
- 250' HAPPY HOSE!<sup>®</sup> capacity
- Easy decontamination
- Cable guide for HAPPY HOSE!<sup>®</sup>
- Installs vertically or horizontally
- Locking holster for pump storage
- Removable reel handle
- Can be shipped UPS

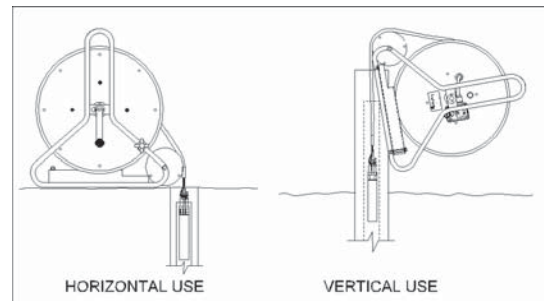

**Instrumentation  
Northwest, Inc.**

**1-800-776-9355**  
<http://www.inwusa.com>



## DIMENSIONS AND SPECIFICATIONS

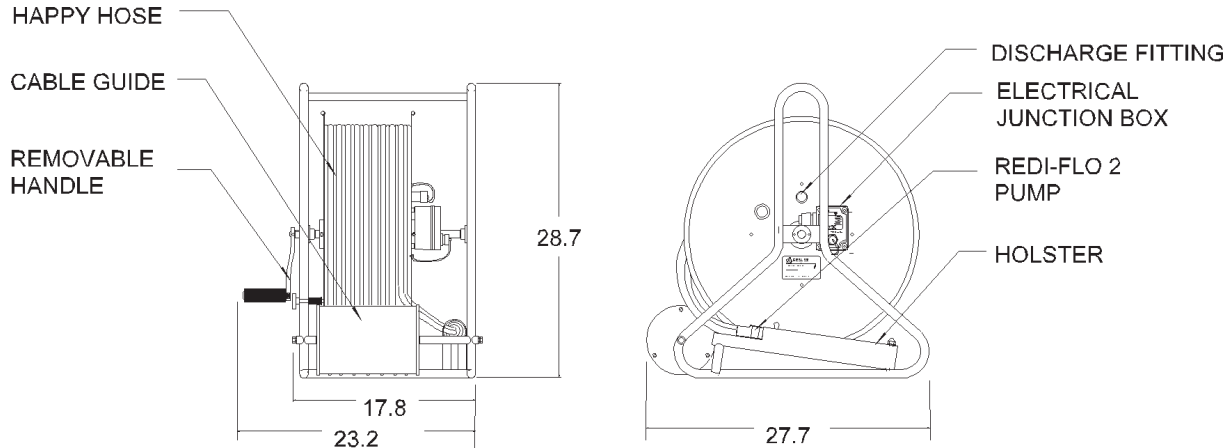

## HOW TO ORDER

- Specify *REEL E-Z* system.
- Specify HAPPY HOSE! or HAPPY CABLE! material.
- Order options and accessories as needed.

### REEL E-Z SYSTEMS w/ HAPPY HOSE!/CABLE!

<b>3P015</b>	100' <i>REEL E-Z</i> System w/ PVC HAPPY HOSE!
<b>3P030</b>	200' <i>REEL E-Z</i> System w/ PVC HAPPY HOSE!
<b>3P302</b>	150' <i>REEL E-Z</i> System w/ TLPE HAPPY HOSE!
<b>3P304</b>	250' <i>REEL E-Z</i> System w/ TLPE HAPPY HOSE!
<b>3P333</b>	250' <i>REEL E-Z</i> System w/ PE HAPPY CABLE!

### ACCESSORIES

<b>3P853</b>	Variable Frequency Drive (VFD)
<b>3P210</b>	1/2" ID Tubing Check Valve-Option (factory installed)
<b>3P212</b>	3/8" ID Tubing Check Valve-Option (factory installed)
<b>3J115</b>	.45µm High-Capacity, In-Line Filter
<b>3P175</b>	Removable Pump Shroud
<b>3P110</b>	Wheel Kit

Information in this document is subject to change without notice

## MECHANICAL

<b>Weight</b> (without pump & hose)	25 lbs.
<b>Materials of Construction</b>	Aluminum, PE, 300 Series S.S.
<b>HAPPY HOSE! Capacity</b>	PVC: 200' TLPE: 250'
<b>HAPPY CABLE! Capacity</b>	250'
<b>Discharge Fitting</b>	3/4" S.S. standard garden hose thread
<b>Cable Guide</b>	8" diameter
<b>Sample Hose Length</b>	PVC 16' TLPE 8'

## ELECTRICAL

<b>Electrical Connector</b>	NEMA 6P rating 4 pole quick connect
<b>Junction Box</b>	NEMA 6P rating
<b>HAPPY CABLE! O.D.</b>	7/16"
<b>Jacket</b>	PVC, PE or FEP Teflon
<b>Motor Lead</b>	PVC, Teflon or PE insulated 18 AWG wire
<b>Converter Cable Length</b>	12'

## Instrumentation Northwest, Inc.



### Sales and Service Locations

8902 122nd Ave NE, Kirkland • Washington 98033 USA  
 (425) 822-4434 • (425) 822-8384 FAX • info@inwusa.com  
 4620 Northgate Boulevard, Suite 170 • Sacramento, California 95834  
 (916) 922-2900 • (916) 648-7766 FAX • inwsw@inwusa.com